

INSTALLATION INSTRUCTIONS

8MM SLIDING DOOR

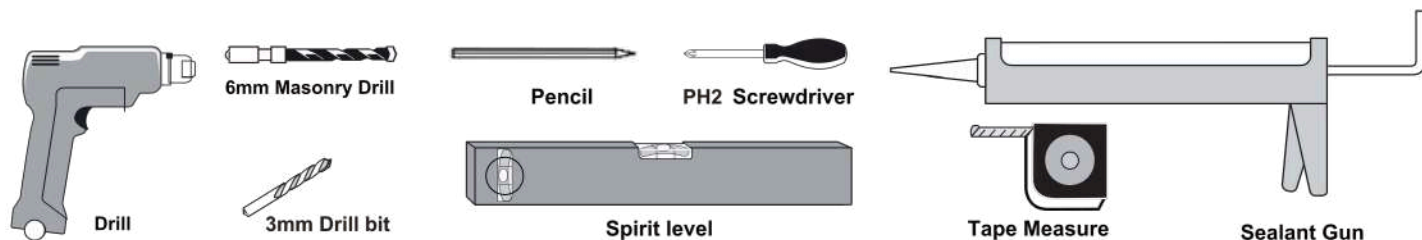

Tools Required (not supplied)

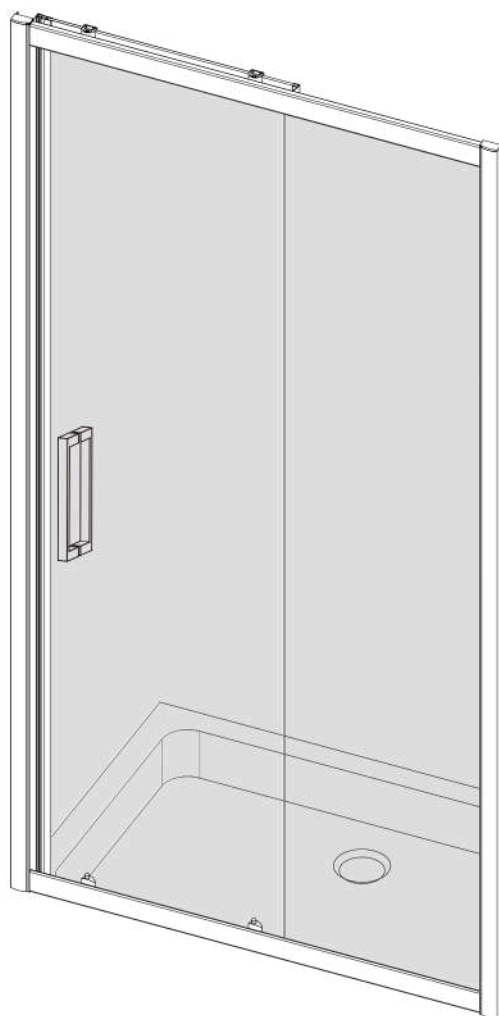

Important Safety/Assembly Instructions

This product should be installed by a suitably qualified and proficient person. The fitting instructions should be followed carefully to ensure a proper and safe installation. Failure to follow these instructions could result in future injury.

These instructions and list of parts assume that installation is done against solid/tiled walls. Please check this product for damage prior to starting the installation. No claims can be made after the product has been fitted.

PLEASE NOTE :The minimum and maximum adjustment sizes noted on the product brochures are based on perfectly plumb walls and trays.

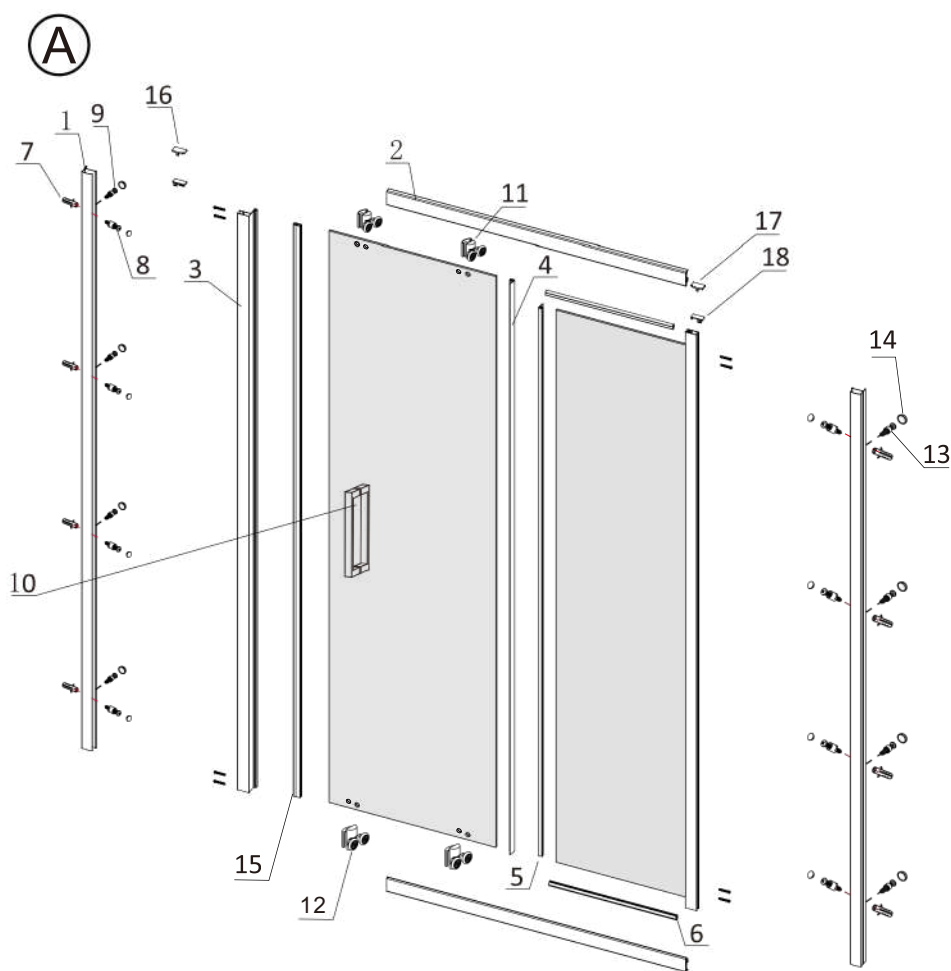

Item	Description	Image	Qty
1	Wall Profile		2
2	Top & Bottom Rail		2
3	Magnetic Profile		1
4	Vertical Seal Longer		1
5	Vertical Seal Shorter		1
6	Gasket Seal		2
7	Wall Plug		8
8	Screw M4x30		16
9	Screw M4x10		8
10	Handle		1
11	Top Roller		2
12	Bottom Roller		2
13	Screw Cup		16
14	Screw Cover Cap		16
15	Magnetic Seal		1
16	Wall Profile Top Cap-LH		1
17	Wall Profile Top Cap-RH		1
18	Vertical Profile Top Cap		2

Note: If the glass has a glass treatment, ensure that the treated side is on the inside of the enclosure. The treated side of the glass will have a label attached to the treated side.

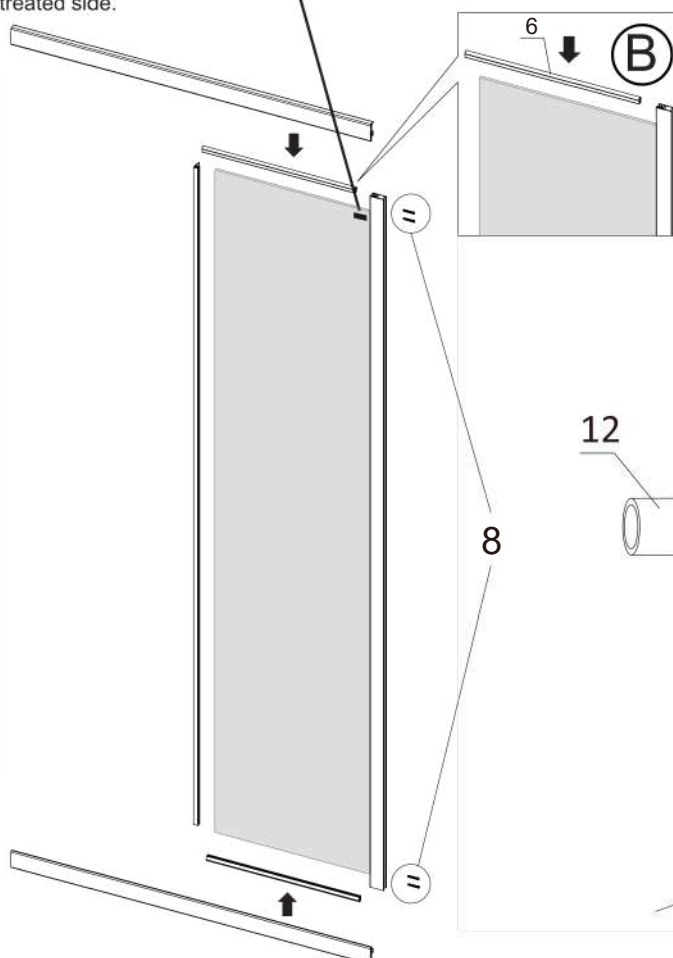
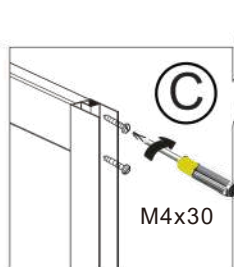

Skip the item 12 & 13 if your door is supplied with cover strips.

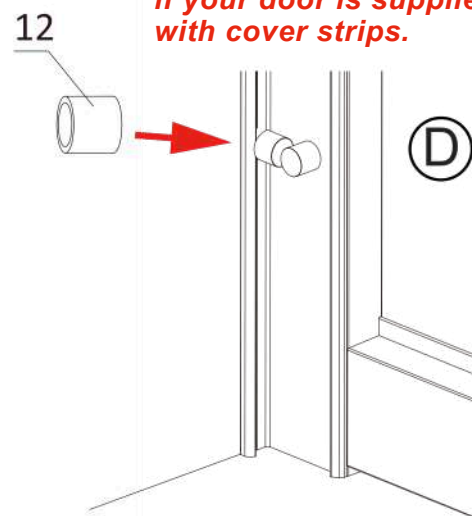

E.1 Place the wall profiles onto the enclosure. Position the enclosure onto the tray. Ideally the enclosure should be positioned 20mm from the edge of the tray as shown. Centralize the enclosure onto the tray top rim and position vertically plumb using a spirit level.

E.2 Mark the position for fixing the wall profile using a pencil or a water soluble pen as shown.

E.3 Remove the enclosure then drill the holes to the wall using $\varnothing 6$ drill bit as shown.

E.4 Insert the wall plugs into the wall holes. Then Secure the wall profile using ST 4 x 30 screw and Screw Cup. Then put the Screw cap on to hide the screw head.

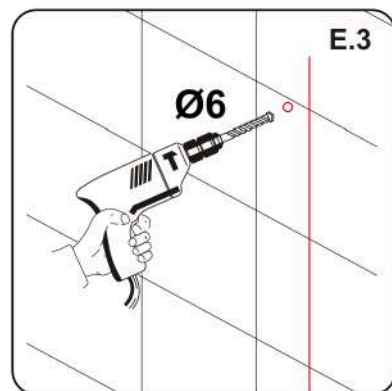
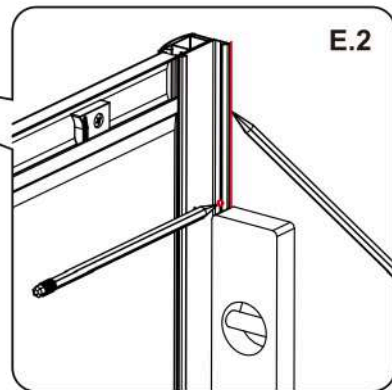
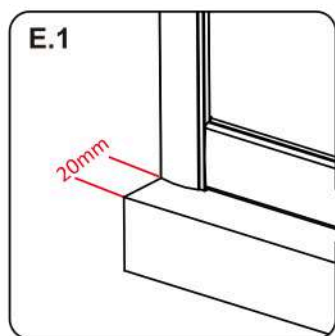
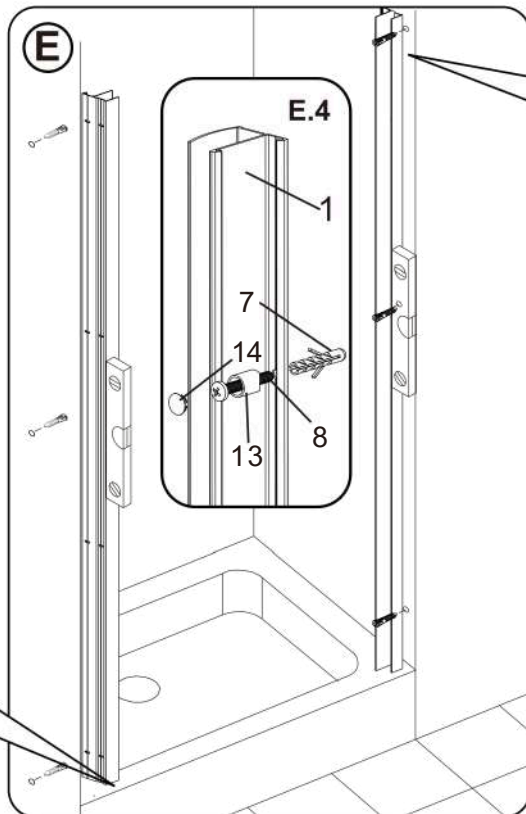

I TOP ROLLER 10

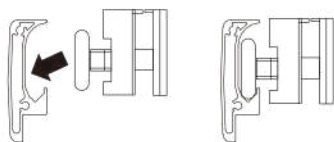

BOTTOM ROLLER 11

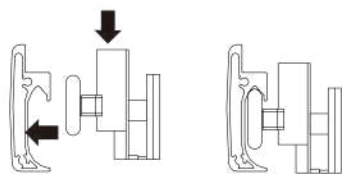

The top and bottom rollers **MUST** be placed in their correct positions i.e. top and bottom, otherwise the door will not function correctly and could lead to excessive wear and tear.

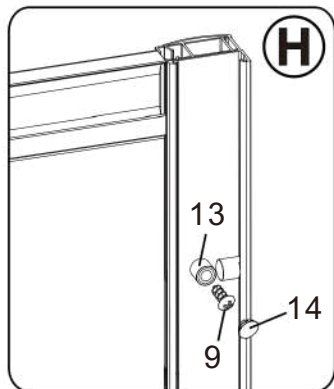
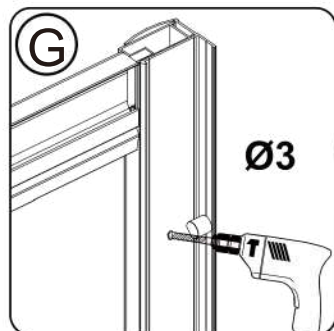
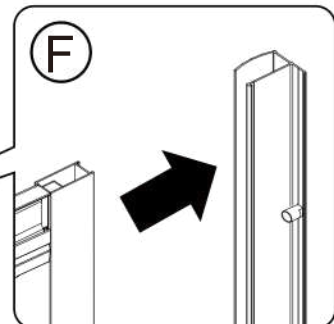
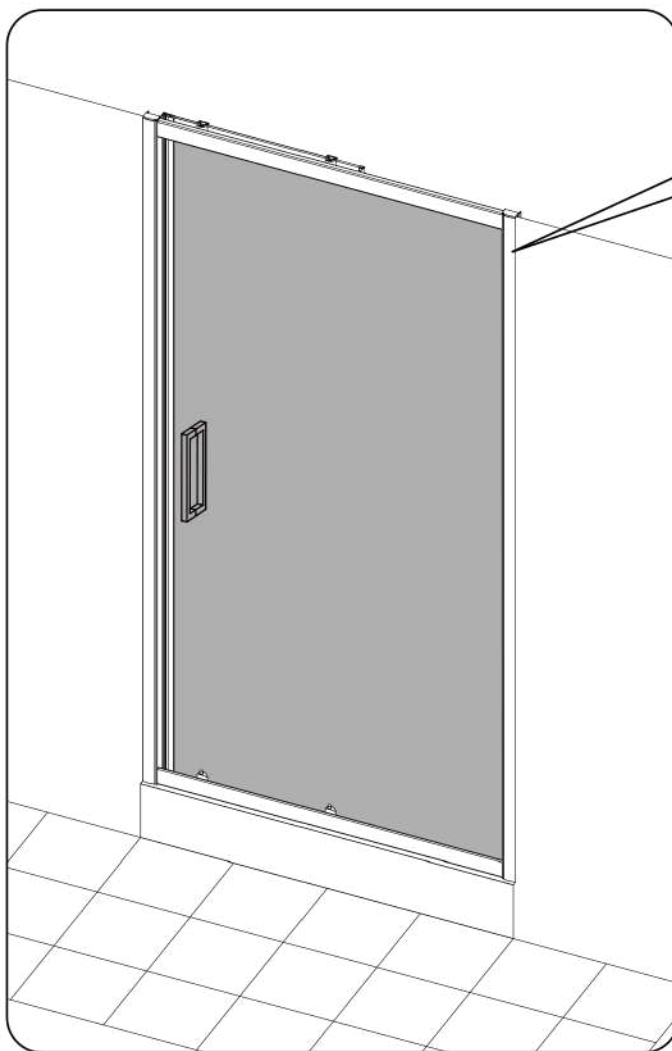

Tips - In cold weather the seal may be more difficult to fit. In this case it is advisable to warm the seal in some warm soapy water to make it more pliable.

Applying Silicone Sealant

Sealing Inside

Seal from the top of the wall profile to the bottom on the **INSIDE** between the wall profile and the wall.

IMPORTANT: Do not apply sealant on inside of tray.

Sealing Outside

Seal only along the bottom rail and glass on the **OUTSIDE** between the profile /glass and the tray. Also up between the wall profile and the wall. Seal also the joints between the bottom profile and any upright profiles.

24 HRS



DO NOT USE THE ENCLOSURE FOR 24 HOURS AFTER SEALING

J 17

18

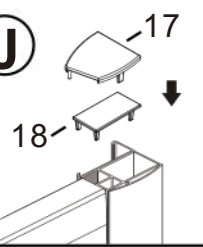

seal

K

4

5



10

M

inside

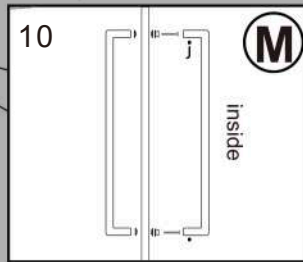

15

L

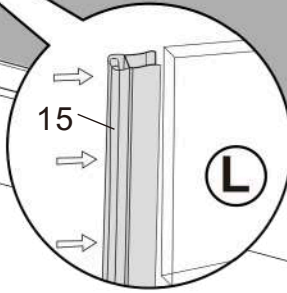

If the wheels do not fit into the profile, the door can be lowered by adjusting the top runners

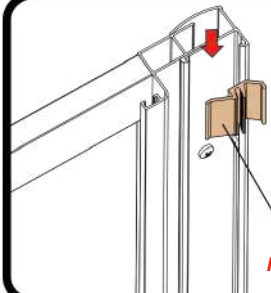

Plastic Clamp

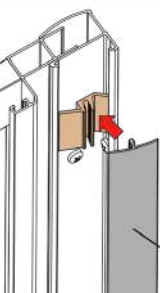

Cover Strips

